

HS260

Payload 260Kgf

Installation method		Application	
Floor	●	Spot welding	●
Ceiling		Arc welding	
Wall surface		Handling	●
		Assembly	
		Sealing	●
		Painting	

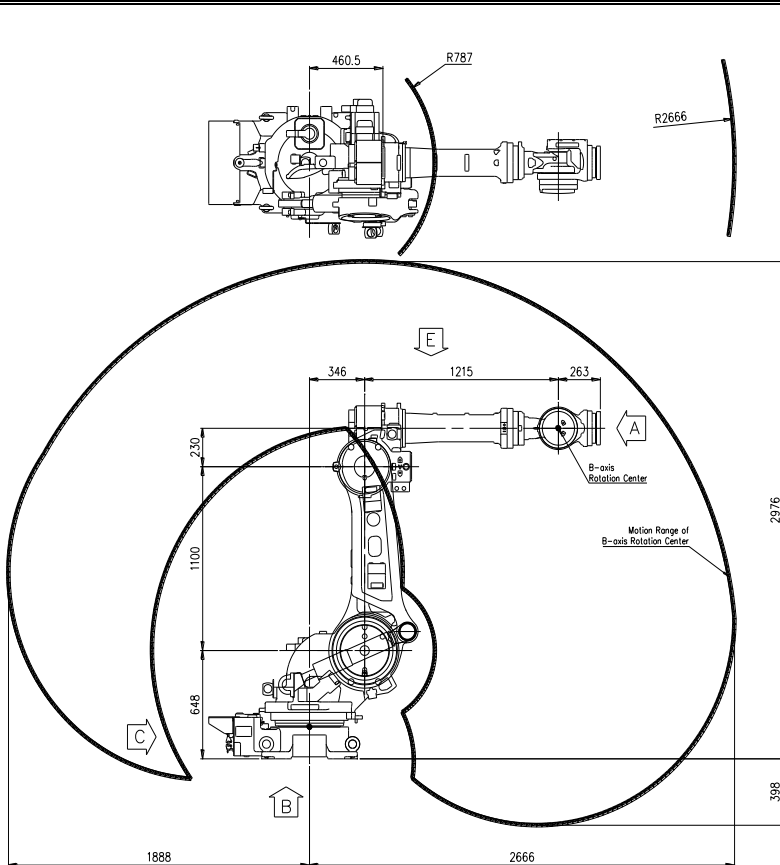

View A: Detailed drawing of the wrist attachment part

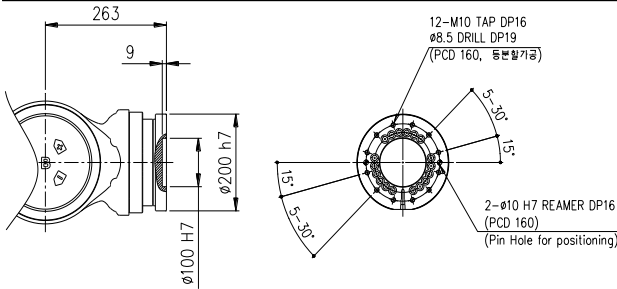

View B: Dimensional drawing for the floor installation of the body

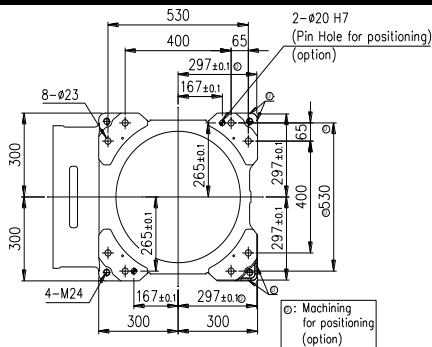

Wrist-axis torque line diagram

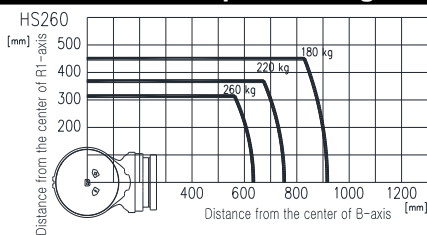

** For product improvement, some of the ratings, specifications, dimensions, etc. are subject to changes without notice.

Item		Specification	
Robot model		HS260	
Payload		260 Kg	
Structure		Articulated	
Degree of freedom		6 axes	
Drive system		AC SERVO MOTOR	
Max. working envelope	Arm	S Swivel	$\pm 3.141 \text{ rad } (\pm 180^\circ)$
		H Horizontal	$+2.705 \sim +0.174 \text{ rad } (+155^\circ \sim +10^\circ)$
	V Vertical	$+3.316 \sim -1.396 \text{ rad } (+190^\circ \sim -80^\circ)$	
	Wrist	R2 Rotation 2	$\pm 6.283 \text{ rad } (\pm 360^\circ)$
		B Bending	$\pm 2.094 \text{ rad } (\pm 128^\circ)$
R1 Rotation 1		$\pm 6.283 \text{ rad } (\pm 360^\circ)$	
Max. working speed	Arm	S Swivel	$1.919 \text{ rad / s } (110^\circ / \text{s})$
		H Horizontal	$1.850 \text{ rad / s } (106^\circ / \text{s})$
	V Vertical	$1.920 \text{ rad / s } (110^\circ / \text{s})$	
	Wrist	R2 Rotation 2	$2.443 \text{ rad / s } (140^\circ / \text{s})$
		B Bending	$2.443 \text{ rad / s } (140^\circ / \text{s})$
R1 Rotation 1		$3.665 \text{ rad / s } (210^\circ / \text{s})$	
Wrist torque	R2 Rotation 2	$1,618 \text{ Nm } (165 \text{ kgfm})$	
	B Bending	$1,618 \text{ Nm } (165 \text{ kgfm})$	
	R1 Rotation 1	$794 \text{ Nm } (81 \text{ kgfm})$	
Accuracy of position repeatability		$\pm 0.05 \text{ mm}$	
Ambient Temperature		$0 \sim 45^\circ \text{ C } (273 \sim 318 \text{ K})$	
Robot's Weight		1,250 Kg	
Working envelope section area		8.92 m^2	

* When the optional limit switch is attached, the action range of the main axis will be limited (see the manual)

View C: Application cable connection part

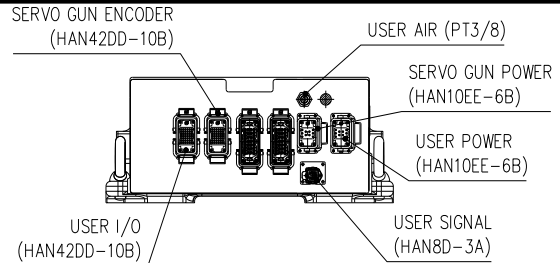

View D: Application cable connection part

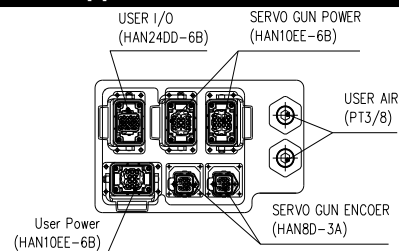

View E: Details of the application ancillary part attachment

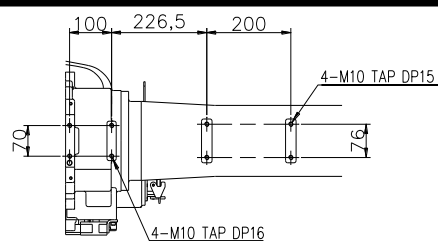

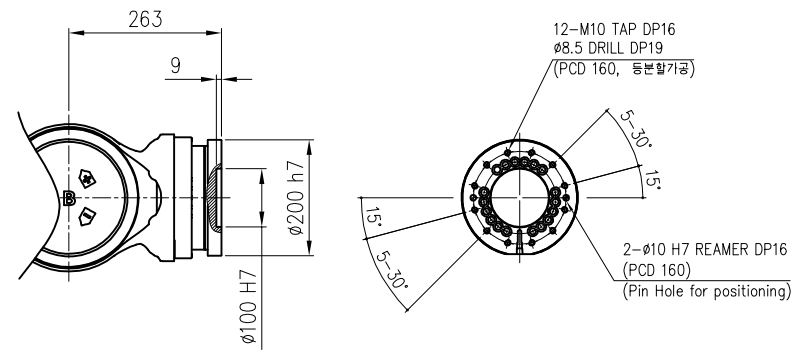

VIEW "A"
(SCALE : 2/1)

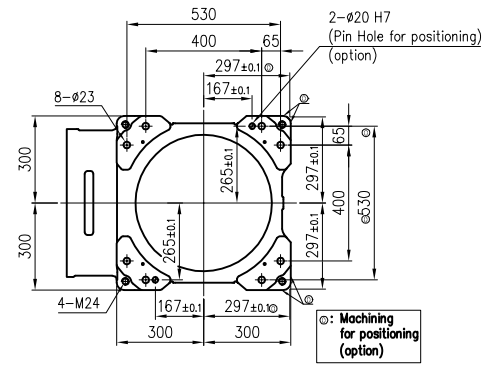

VIEW "B"
(SCALE : 1/1)

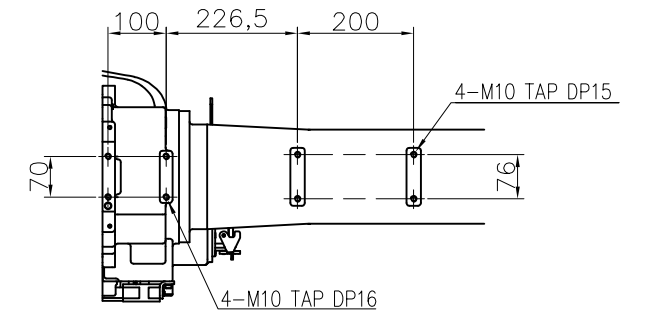

VIEW "E"
(SCALE : 2/1)

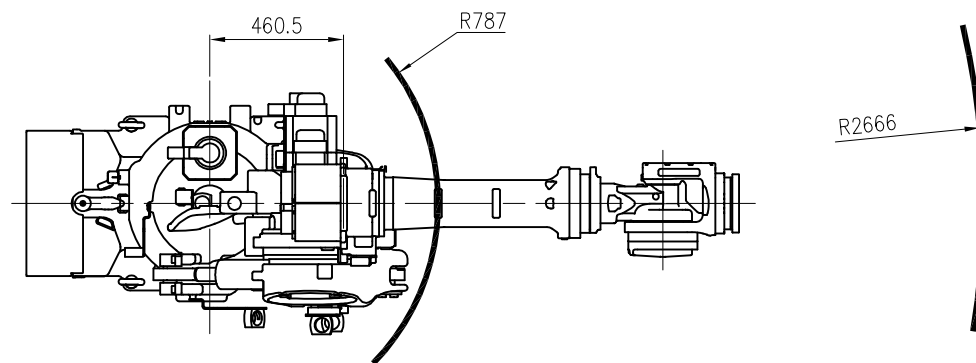

VIEW "C"
(SCALE : 2/1)

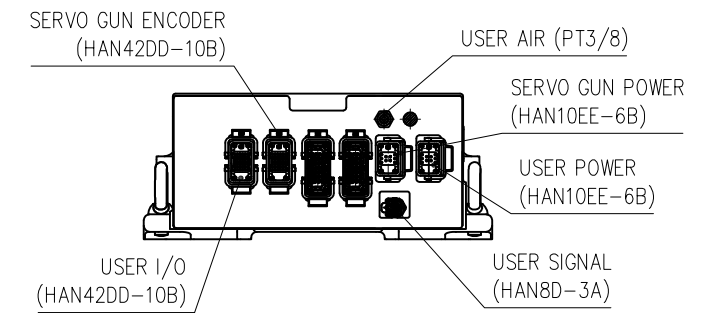

VIEW "D"
(SCALE : 2/1)

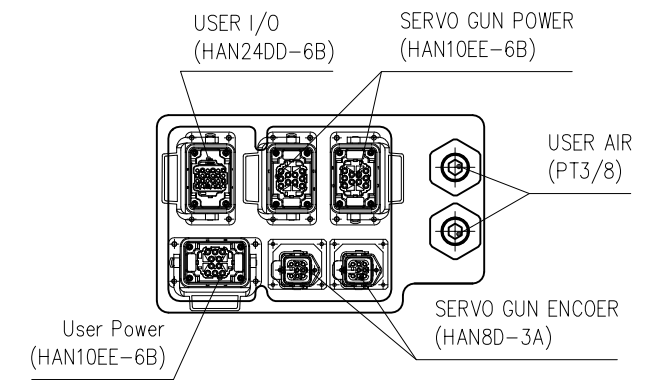
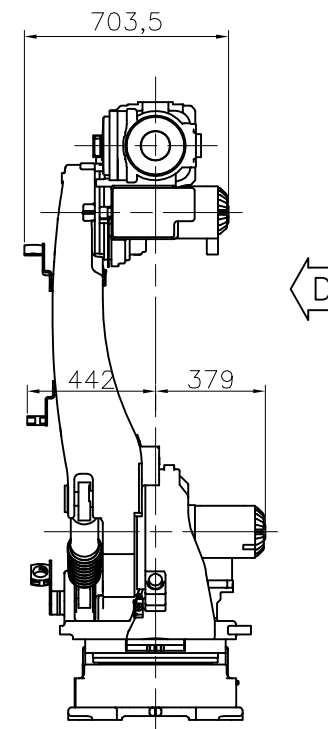
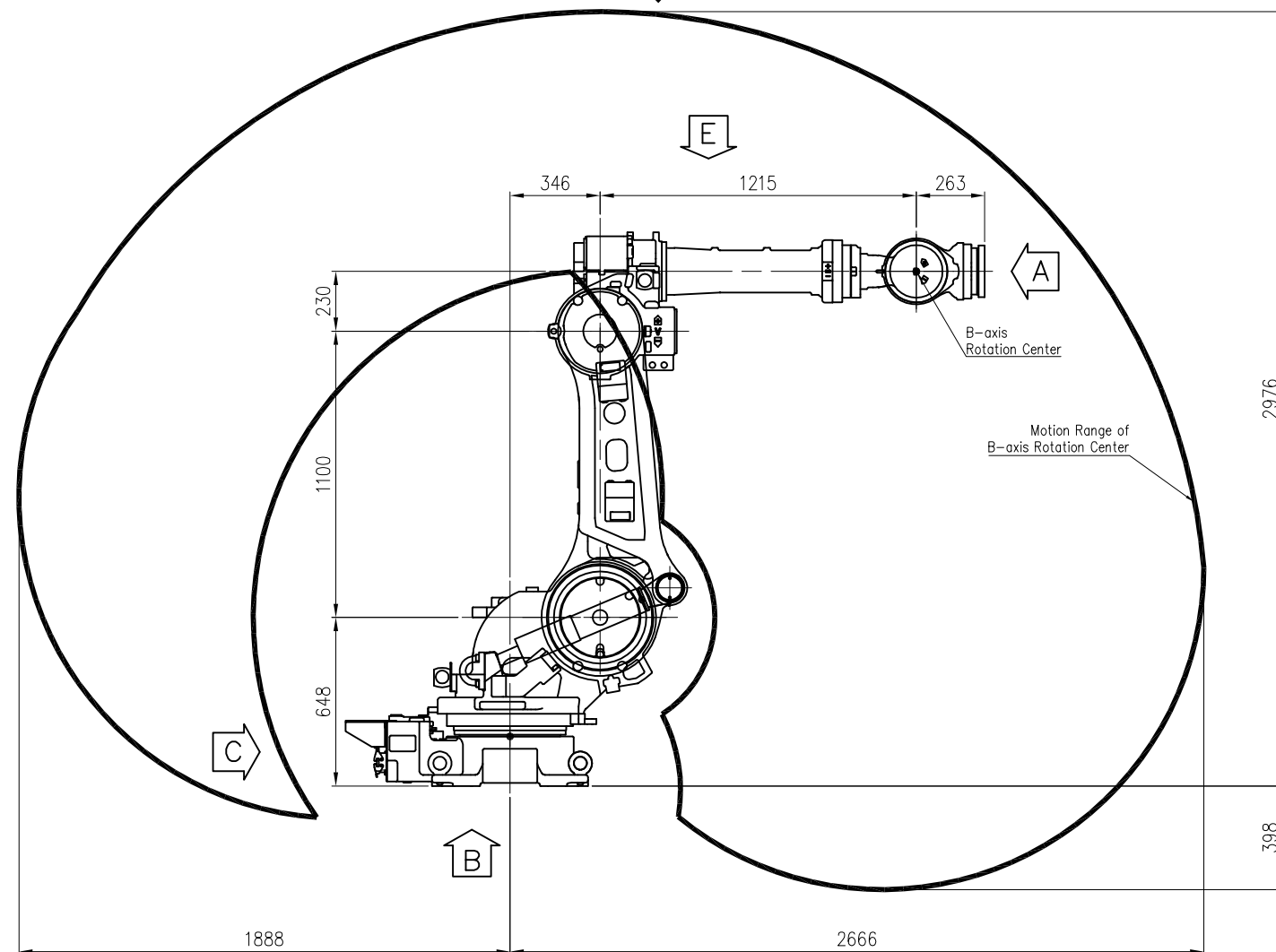

TECHNICAL SPECIFICATION SUBJECT TO
CHANGE WITHOUT NOTICE

MODEL	HS260	issue.0
DATE	2018.06.19	

HYUNDAI ROBOTICS