

HS160L

Payload 160Kgf

Installation method	Application
Floor	●
Ceiling	
Wall surface	
	Spot welding ●
	Arc welding ●
	Handling ●
	Assembly ●
	Sealing ●
	Painting ●

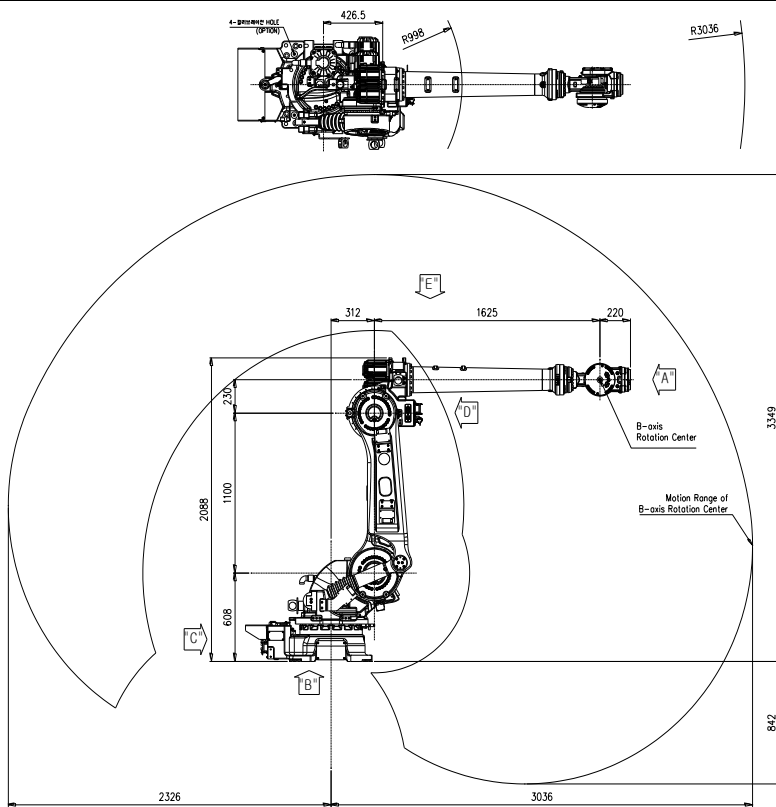

View A: Detailed drawing of the wrist attachment part

OLD

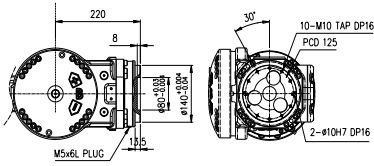

NEW

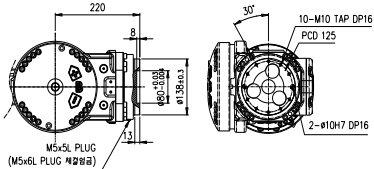

View B: Dimensional drawing for the floor installation of the body

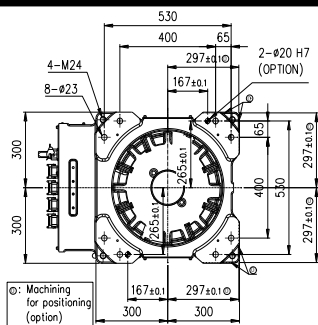

Wrist-axis torque line diagram

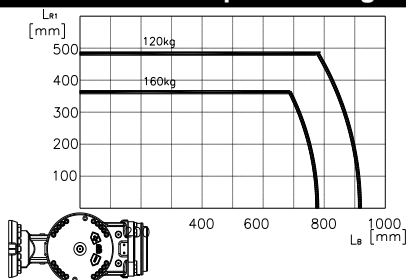

Item	Specification
Robot model	HS160L
Payload	160 Kg
Structure	Articulated
Degree of freedom	6 axes
Max. working envelope	A S Swivel $\pm 3.142 \text{ rad } (\pm 180^\circ)$
	r H Horizontal $+2.705 \sim 0.175 \text{ rad } (+155^\circ \sim +10^\circ)$
	m V Vertical $+3.316 \sim -1.396 \text{ rad } (+190^\circ \sim -80^\circ)$
	Wrist R2 Rotation 2 $\pm 6.284 \text{ rad } (\pm 360^\circ)$
	B Bending $\pm 2.234 \text{ rad } (\pm 128^\circ)$
Max. working speed	A S Swivel 1.658 rad / s (120° / s)
	r H Horizontal 1.484 rad / s (115° / s)
	m V Vertical 1.484 rad / s (115° / s)
	Wrist R2 Rotation 2 2.094 rad / s (174° / s)
	B Bending 2.094 rad / s (172° / s)
Wrist torque	R1 Rotation 1 3.316 rad / s (260° / s)
	R2 Rotation 2 1,079 Nm (110 kgfm)
	B Bending 1,079 Nm (110 kgfm)
repeatability	$\pm 0.15 \text{ mm}$
Ambient Temperature	0 ~ 45 °C (273 ~ 318 K)
Robot's Weight	985 Kg

**) When the optional limit switch is attached, the action range of the main axis will be limited (see the manual)*

View C: Application cable connection part

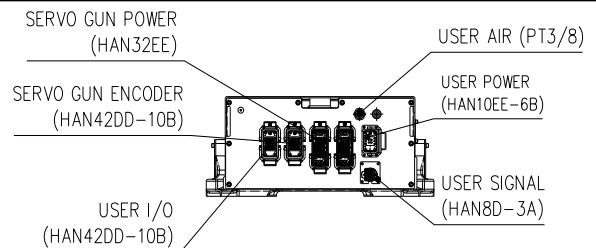

View D: Application cable connection part

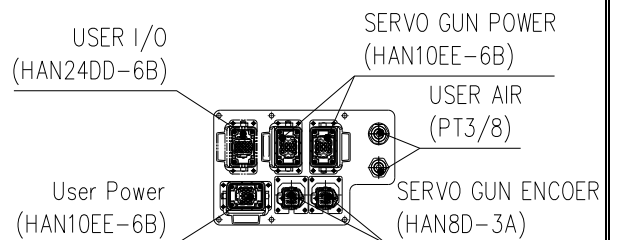

View E: Details of the application ancillary part attachment

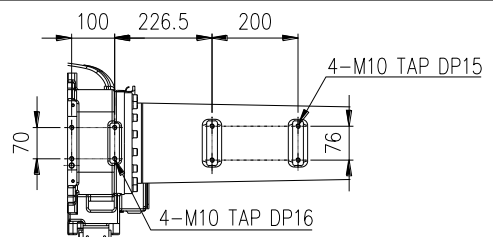

**** For product improvement, some of the ratings, specifications, dimensions, etc. are subject to changes without notice.**

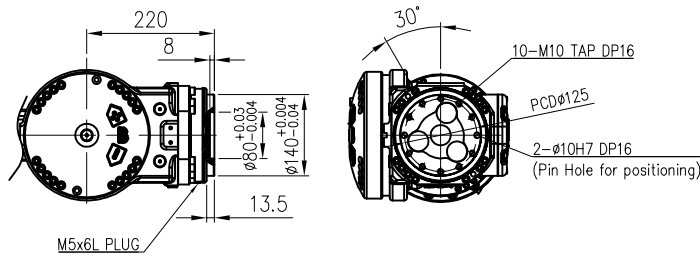

VIEW "A" (OLD)
(SCALE : 2/1)

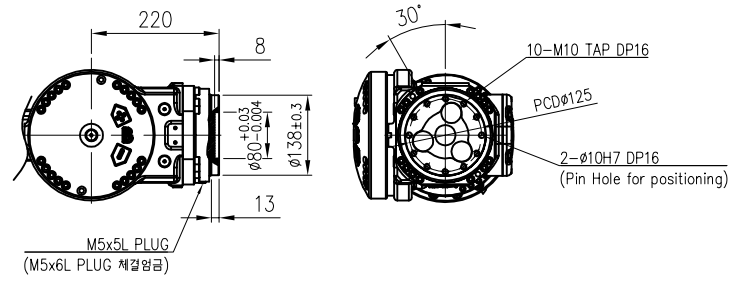

VIEW "A" (NEW)
(SCALE : 2/1)

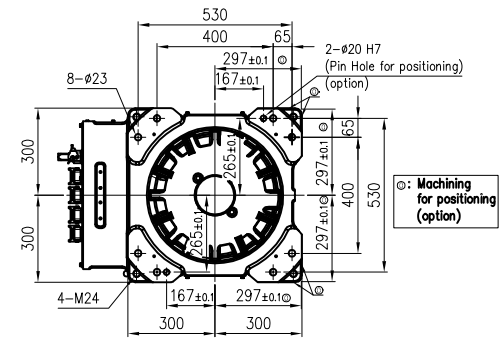

VIEW "B"
(SCALE : 1/1)

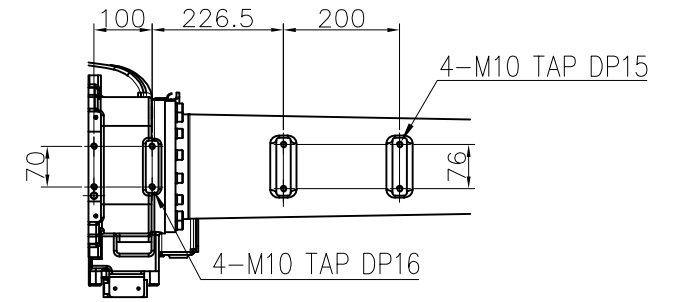

VIEW "E"
(SCALE : 2/1)

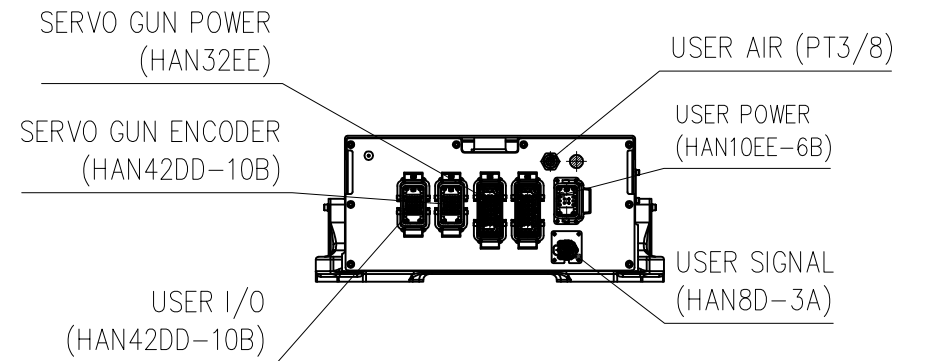
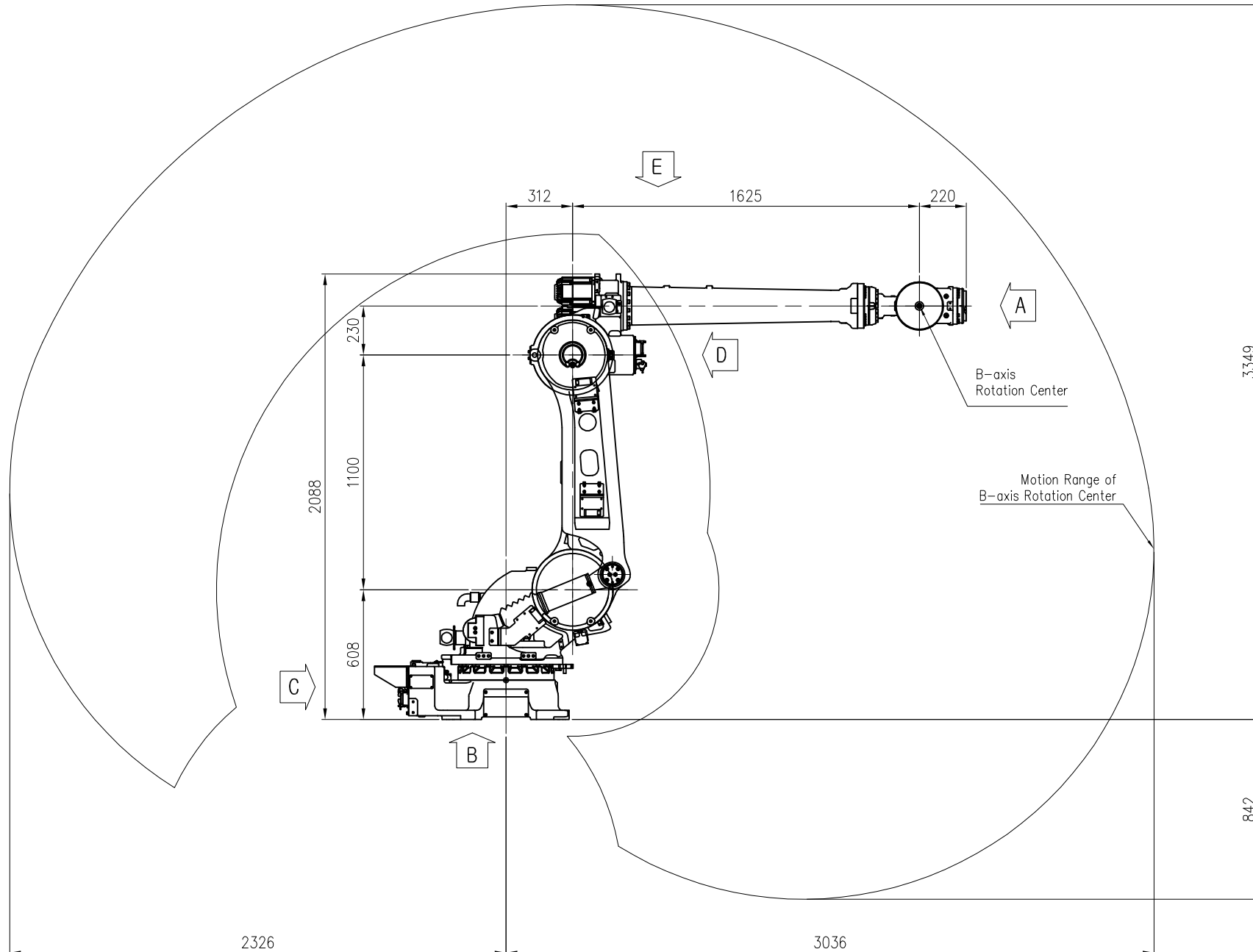
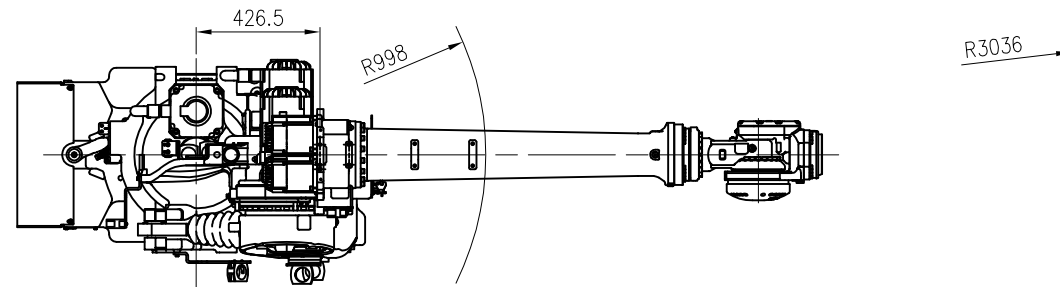

VIEW "C"
(SCALE : 2/1)

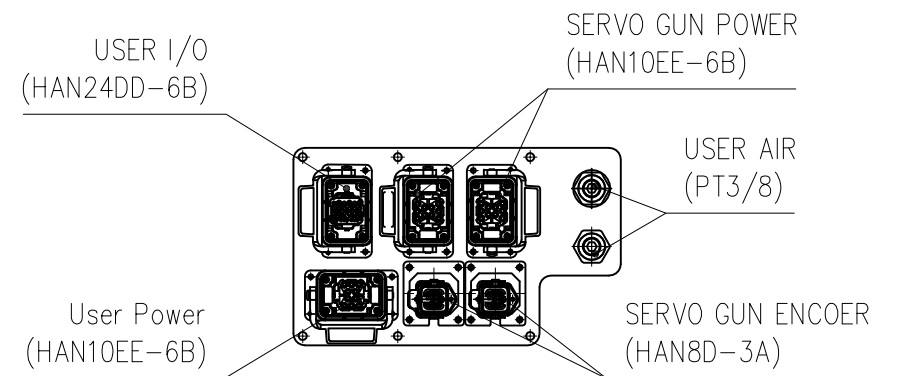
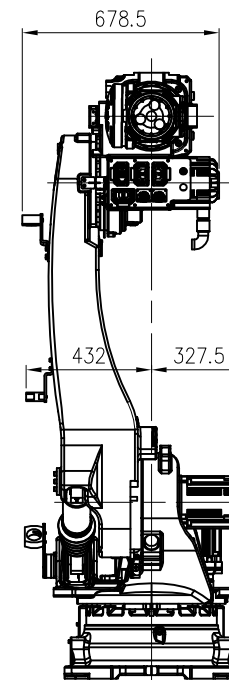

VIEW "D"
(SCALE : 4/1)

TECHNICAL SPECIFICATION SUBJECT TO CHANGE WITHOUT NOTICE

MODEL	HS160L	issue.0
DATE	2018.06.19	

