

HH8

Installation method		Application	
Floor	●	Spot welding	
Ceiling	●	Arc welding	
Wall surface	●	Handling	●
		Assembly	
		Sealing	
		Painting	

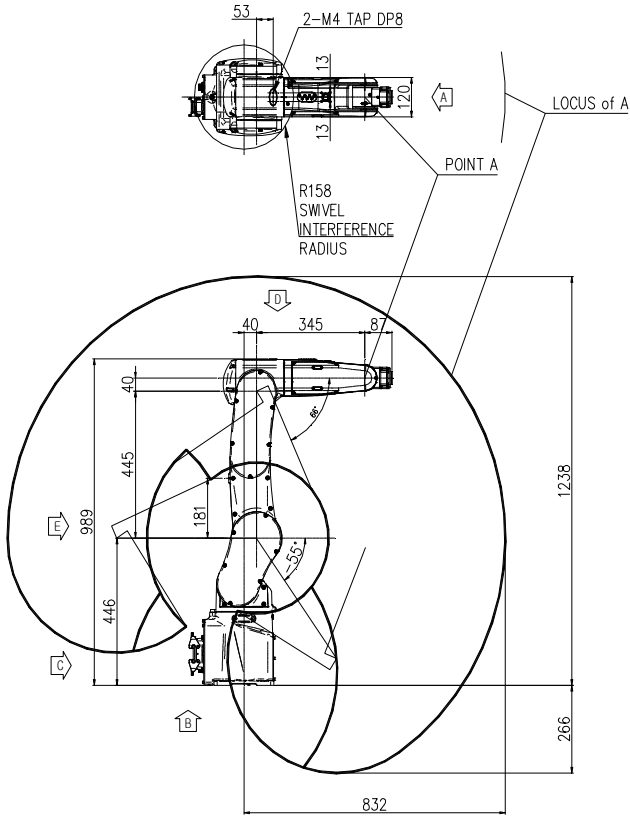

View A: Detailed drawing of the wrist attachment part

Item		Specification		
Robot model		HH8		
Payload		8 Kg		
Structure		Articulated		
Degree of freedom		6 axes		
Drive system		AC SERVO MOTOR		
Max. working envelope	Arm	A	S Swivel	± 2.967 rad ($\pm 170^\circ$)
		H	Horizontal	55°
		V	Vertical	$+3.71 \sim -1.22$ rad ($+213^\circ \sim -70^\circ$)
	Wrist	R2	Rotation 2	± 3.316 rad ($\pm 190^\circ$)
		B	Bending	± 2.356 rad ($\pm 135^\circ$)
Max. working speed	Arm	R1	Rotation 1	± 6.283 rad ($\pm 360^\circ$)
		A	S Swivel	7.941 rad / s (455° / s)
		H	Horizontal	6.719 rad / s (385° / s)
	Wrist	V	Vertical	9.075 rad / s (520° / s)
		R2	Rotation 2	9.599 rad / s (550° / s)
Wrist torque	B	Bending	9.599 rad / s (550° / s)	
	R1	Rotation 1	17.453 rad / s (1000° / s)	
	R2	Rotation 2	17 N.m (1.73 Kgf.m)	
		B	Bending	17 N.m (1.73 Kgf.m)
		R1	Rotation 1	10 N.m (1.02 Kgf.m)
Accuracy of position repeatability		± 0.02 mm		
Ambient Temperature		$0 \sim 45^\circ\text{C}$ ($273 \sim 318$ K)		
Robot's Weight		41 Kg		
Working envelope section area		1.46 m ²		

***) When the optional limit switch is attached, the action range of the main axis**

will be limited (see the manual)

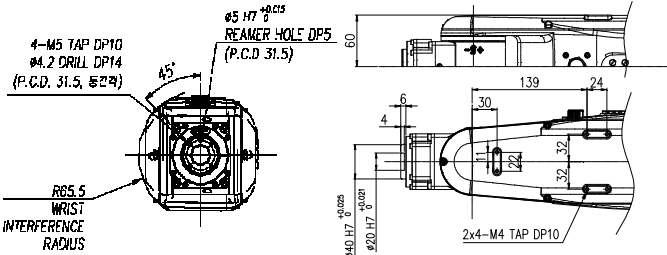

View B: Dimensional drawing for the floor installation of the body

View G: Application part mounting

View C: Application cable connection part

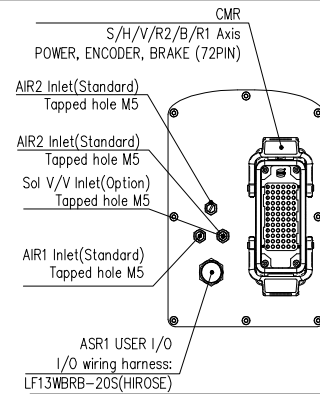

View D: Application cable connection part

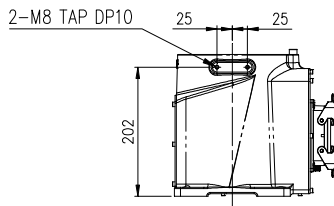
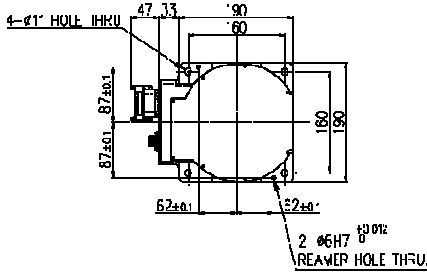

View E: Details of the application ancillary part

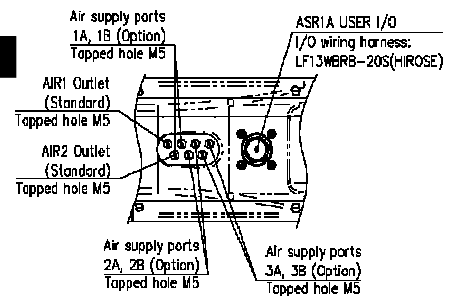

Wrist-axis torque line diagram

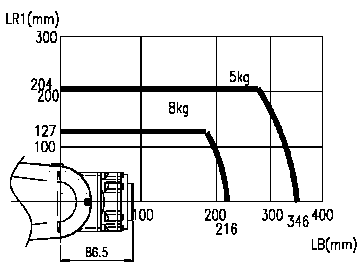

**** For product improvement, some of the ratings, specifications, dimensions, etc. are subject to changes without notice**

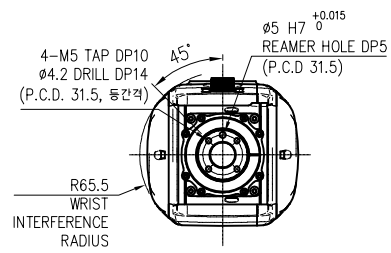

VIEW "A"

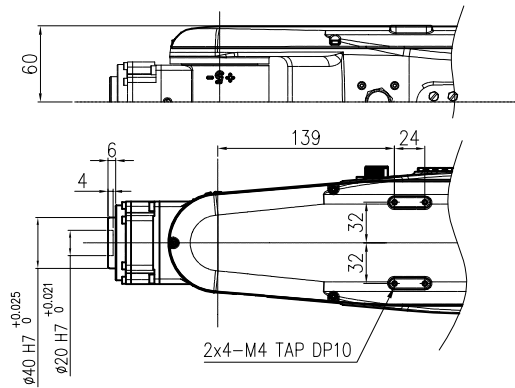

VIEW "F"

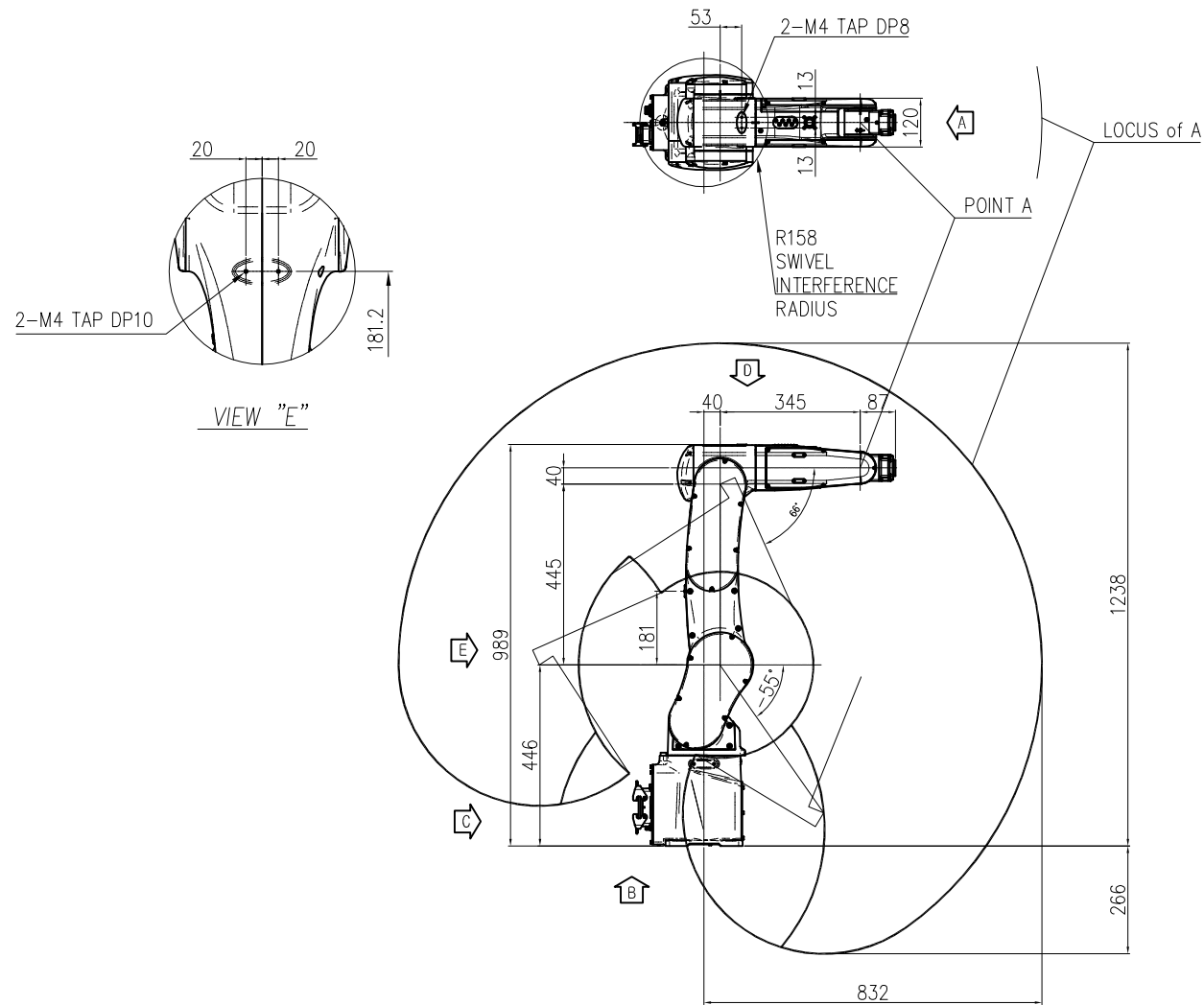

VIEW "E"

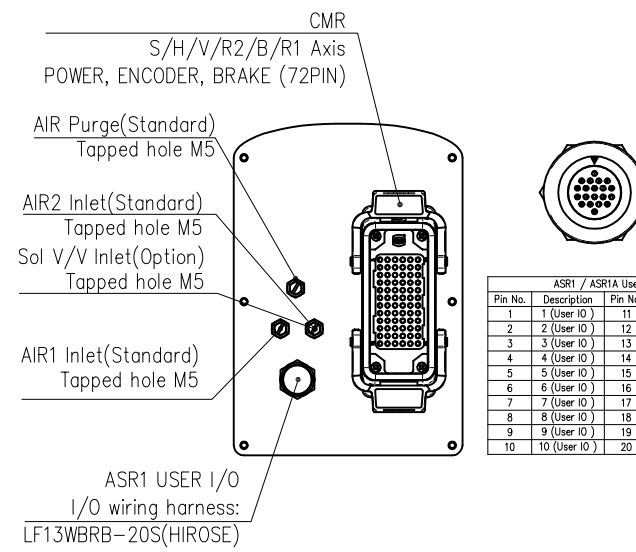

ASR1 / ASR1A User I/O Wiring Harness				
Pin No.	Description	Pin No.	Description	Option
1	1 (User ID)	11	11 (User ID)	
2	2 (User ID)	12	12 (User ID)	1A(sol v/v)
3	3 (User ID)	13	13 (User ID)	1B(sol v/v)
4	4 (User ID)	14	14 (User ID)	2A(sol v/v)
5	5 (User ID)	15	15 (User ID)	2B(sol v/v)
6	6 (User ID)	16	16 (User ID)	3A(sol v/v)
7	7 (User ID)	17	17 (User ID)	3B(sol v/v)
8	8 (User ID)	18	18 (User ID)	G(sol v/v)
9	9 (User ID)	19		
10	10 (User ID)	20		

VIEW "C"

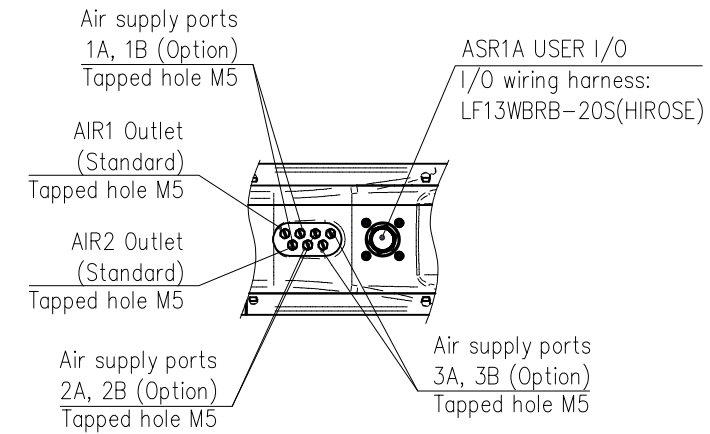

VIEW "D"

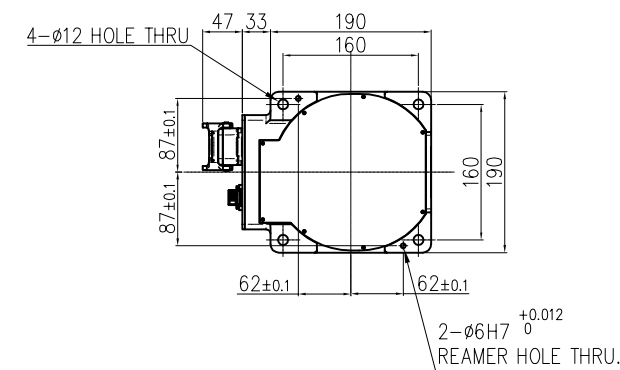

VIEW "B"

TECHNICAL SPECIFICATION SUBJECT TO
 CHANGE WITHOUT NOTICE

MODEL	HH8	issue.0
DATE	2020.03.11	